

EN1092-1/05B Raised Face Blind Flange PN16

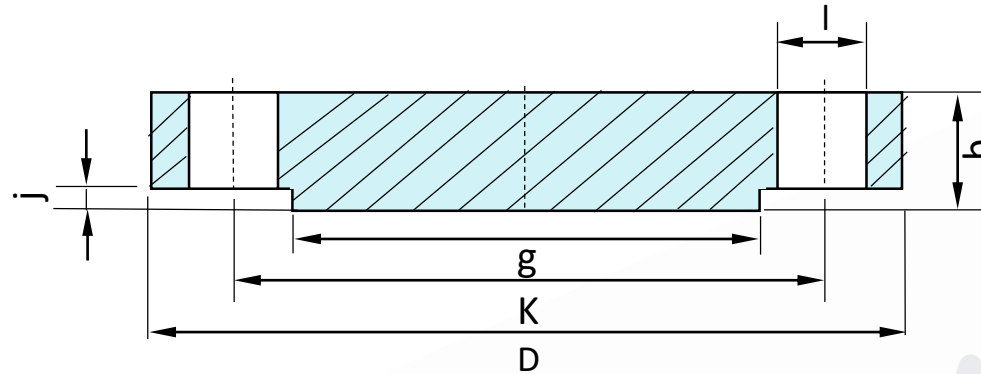

Pipe Nomin size in	O.D	K	D	b	l	Thread	No. of holes	j	g	Weight (kg)
0.50	21.34	65.0	95.0	16.0	14.0	M12	4	2.00	45.0	0.74
0.75	26.67	75.0	105.0	18.0	14.0	M12	4	2.00	58.0	1.05
1	33.40	85.0	115.0	18.0	14.0	M12	4	2.00	68.0	1.28
1.25	42.16	100.0	140.0	18.0	18.0	M16	4	2.00	78.0	1.88
1.50	48.26	110.0	150.0	18.0	18.0	M16	4	3.00	88.0	2.10
2	60.32	125.0	165.0	18.0	18.0	M16	4	3.00	102.0	2.58
2.50	73.03	145.0	185.0	18.0	18.0	M16	4	3.00	122.0	3.31
3	88.90	160.0	200.0	20.0	18.0	M16	8	3.00	138.0	4.26
4	114.30	180.0	220.0	20.0	18.0	M16	8	3.00	158.0	5.25
5	141.30	210.0	250.0	22.0	18.0	M16	8	3.00	188.0	7.65
6	168.28	240.0	285.0	22.0	22.0	M20	8	3.00	212.0	9.86
8	219.08	295.0	340.0	24.0	22.0	M20	12	3.00	268.0	15.50
10	273.05	355.0	405.0	26.0	26.0	M24	12	3.00	320.0	23.99
12	323.85	410.0	460.0	28.0	26.0	M24	12	4.00	378.0	33.62
16	406.40	525.0	580.0	32.0	30.0	M27	16	4.00	490.0	61.48
20	508.00	650.0	715.0	44.0	33.0	M30	20	4.00	610.0	129.82